

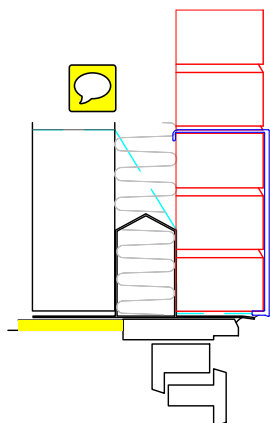

**EASY-SILL**

Installation without complication

# String course installation guide



## Four simple steps are required to install one of our Easy-Sill string courses

1. Remove string course from packaging
2. The row is clipped onto the outer layer of brickwork. It will fit a standard 102.5mm deep brick
3. If the wall is thicker than 102.5mm, the lip snaps off to allow the string course to fit any wall depth
4. Once installed, the course provides a continuous row that runs around the outside of the house and makes the horizontal line of the sills visually more prominent



## Technical data on pultruded profiles reinforced with longitudinal roving and mat. Based on profiles with wall thickness of 3 mm.

Tensile strength longitudinal	450 N/mm <sup>2</sup>
Tensile strength transverse	70 N/mm <sup>2</sup>
Flexural strength longitudinal	400 N/mm <sup>2</sup>
Flexural strength transverse	120 N/mm <sup>2</sup>
E-modulus flexural longitudinal	22000 N/mm <sup>2</sup>
E-modulus flexural transverse	10000 N/mm <sup>2</sup>
Compression strength longitudinal	300 N/mm <sup>2</sup>
Compression strength transverse	80 N/mm <sup>2</sup>
Shear strength	30 N/mm <sup>2</sup>
Shear modulus	3000 N/mm <sup>2</sup>

Elongation at break longitudinal	2,2 %
Elongation at break transverse	1,6 %
Hardness	60 Barcol
Density	1,8

Coeff. Of thermal expansion longit.	8 - 12 x 10 <sup>-6</sup> K <sup>-1</sup>
Coeff. Of thermal expansion transv.	15 - 20 x 10 <sup>-6</sup> K <sup>-1</sup>
Thermal conductivity	0,28 - 0,32 W/mK
Water absorption	0,5 - 2,0 %

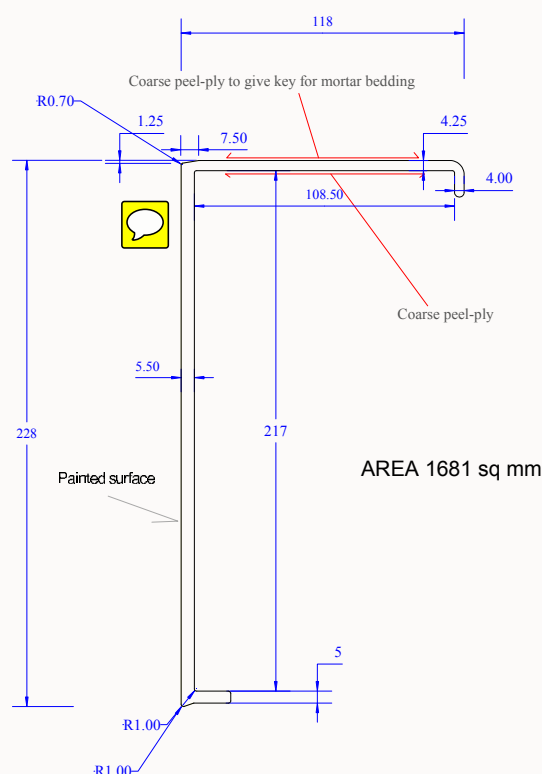

Contact one of our expert team for more details or visit us online  
[www.easy-sill.co.uk](http://www.easy-sill.co.uk) Tel: 0151 363 1367 E-mail: [info@easy-sill.co.uk](mailto:info@easy-sill.co.uk)